

**DOLPHIN DECK**  
Staterooms 1800–1964

**MAIN DECK**  
Staterooms 2500–2715

**LOWER PROMENADE DECK**  
Staterooms 3300–3433

**PROMENADE DECK**

**UPPER PROMENADE DECK**

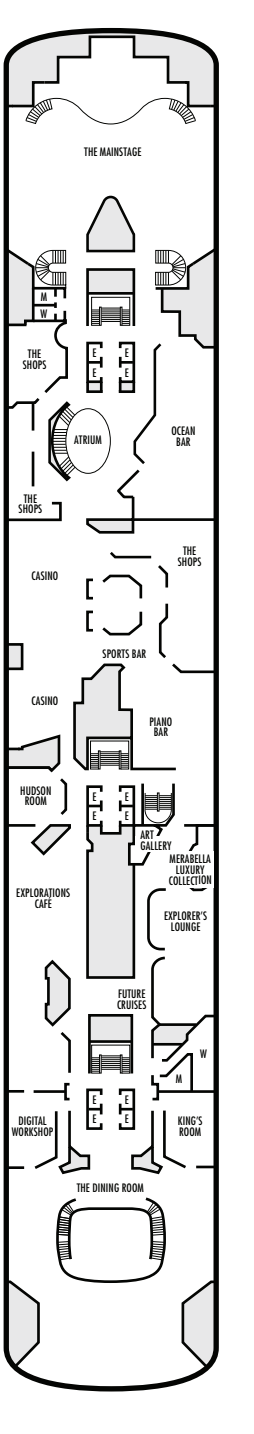
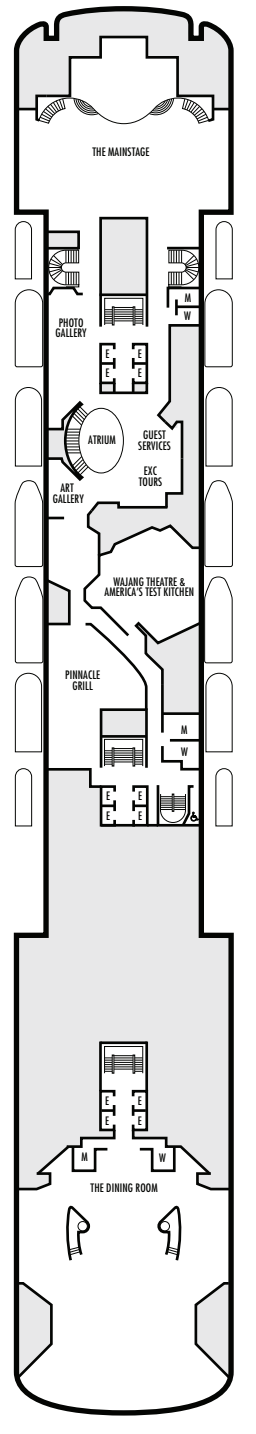
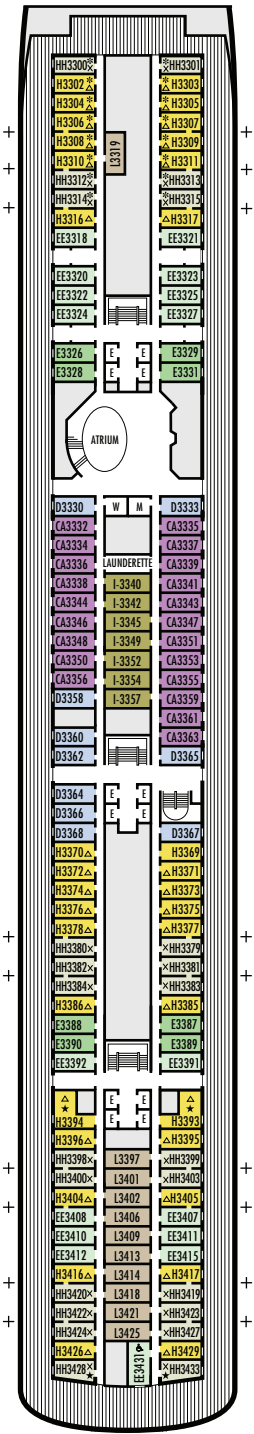
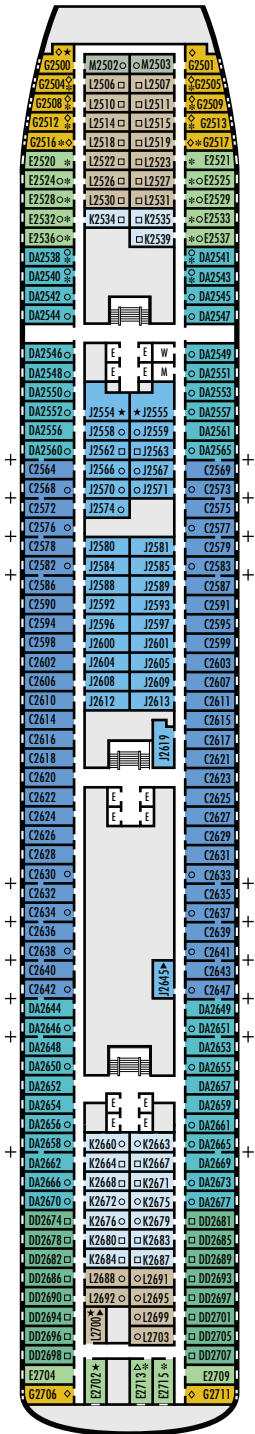
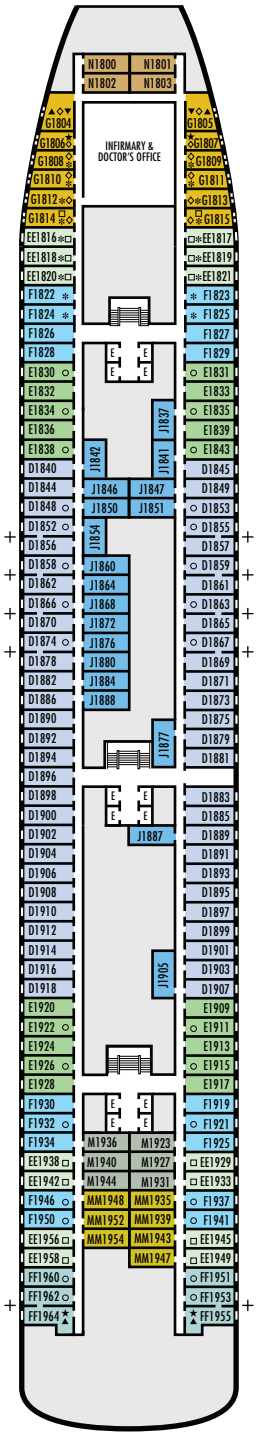

**STATEROOM SYMBOL LEGEND**

- Quad (2 lower beds, 1 sofa bed, 1 upper)
- Triple (2 lower beds, 1 sofa bed)
- ▲ 2 lower beds or converts to 1 queen-size
- △ Partial sea view
- ✕ Fully obstructed view
- \* Shower only
- Bathtub & shower
- ⊕ Connecting rooms
- ◇ These staterooms have portholes instead of windows

**ACCESSIBILITY STATEROOM SYMBOL LEGEND**

- ♿ Suites B6228 & B6225 and stateroom EE3431 are fully accessible, roll-in shower only
- ▼ Suites SA7058 & SA7057 are fully accessible with single side approach to the bed with bathtub & roll-in shower. Staterooms DA6104, G1805 & G1804 are fully accessible with single side approach to the bed, roll-in shower only.
- ★ Staterooms HH3433, HH3428, H3394, H3393, E2702, L2700, J2555, J2554, G2500, FF1964, FF1955, G1807 & G1806 are ambulatory accessible, roll-in shower only

**SHIP SPECIFICATIONS & FACILITIES**

- 1,380 Guests
- 604 Crew
- 62,735 Gross Tons
- 781 Feet Long
- 9 Guest Decks
- Wraparound Promenade Deck
- 6 Restaurants & Cafes
- 6 Entertainment Venues
- 9 Lounges/Bars
- 2 Outdoor Swimming Pools (one with sliding glass roof)
- Spa & Salon
- Fitness Center
- Suite Lounge
- Duty-free Shops
- Library/Internet Cafe
- Onboard Wi-Fi Access
- Casino
- Sport Courts

**VERANDAH DECK**  
Staterooms 6100-6228

**NAVIGATION DECK**  
Staterooms 7001-7058

**LIDO DECK**

**SPORTS DECK**

**MS AMSTERDAM**

**DECK PLANS & STATEROOMS**

The deck plans are colour-coded by category of stateroom, and the category letter precedes the stateroom number in each room. All staterooms are equipped with flat-panel television, DVD player, telephone and multichannel music.

**Important Note:** Not all staterooms within each category have the same furniture configuration and/or facilities. Appropriate symbols within the rooms on the deck plans describe differences from the stateroom descriptions below.

**VERANDAH SUITES**

**PS**

**Pinnacle Suites:** Bedroom with 1 king-size bed, oversize whirlpool bath & shower, living room, dining room, dressing room, private verandah, pantry, 1 sofa bed for 2 persons, mini-bar, refrigerator, guest toilet, floor-to-ceiling windows.

**SA SB**

**Neptune Suites:** 2 lower beds convertible to 1 king-size bed, whirlpool bath & shower, large sitting area, dressing room, private verandah, 1 sofa bed for 2 persons, mini-bar, refrigerator, floor-to-ceiling windows.

**A B BB BC**

**Vista Suites:** 2 lower beds convertible to 1 queen-size bed, whirlpool bath & shower, sitting area, private verandah, mini-bar, refrigerator, floor-to-ceiling windows.

**OCEAN-VIEW STATEROOMS**

**CA**

**Lanai:** 2 lower beds convertible to 1 queen-size bed, bathtub & shower. Sliding glass doors lead onto the walk-around Lower Promenade Deck.

**C D DA DD E EE**

**F FF**

**Large:** 2 lower beds convertible to 1 queen-size bed, bathtub & shower.

**G H HH**

**Large:** 2 lower beds convertible to 1 queen-size bed, bathtub & shower. All G-category staterooms have portholes. All H-category staterooms have partial sea views. All HH-category staterooms have fully obstructed views.

**INTERIOR STATEROOMS**

**I J K L M MM**

**N**

**Large:** 2 lower beds convertible to 1 queen-size bed, shower.

